



4/2 Crowley Crescent MELROSE PARK NSW

3  2  2 

This double brick, private villa is beautifully maintained, impeccably finished, very clean and nicely presented. It enjoys an outlook a lovely green outlook over Meadowbank Park.

Large lounge and split level dining room with bamboo flooring, gas bayonet for heating and air-conditioner.

Modern kitchen overlooks the lounge room and presents in 'aubergine' coloured polyurethane cabinetry, plenty of cupboard and bench space, gas cooking, half drawer dishwasher and stone bench tops

All bedrooms are large and have plush carpets and built-in robes.

Spacious main bedroom opens to the rear courtyard, it has a ceiling fan, split system air conditioning and an en-suite

The main bathroom has ceiling-to-floor tiles, separate shower and bath.

Features and Inclusions: Remote Double Garage. Large

View : <https://www.awardgroup.com.au/lease/nsw/north-ern-suburbs/melrose-park/residential/villa/5229349>

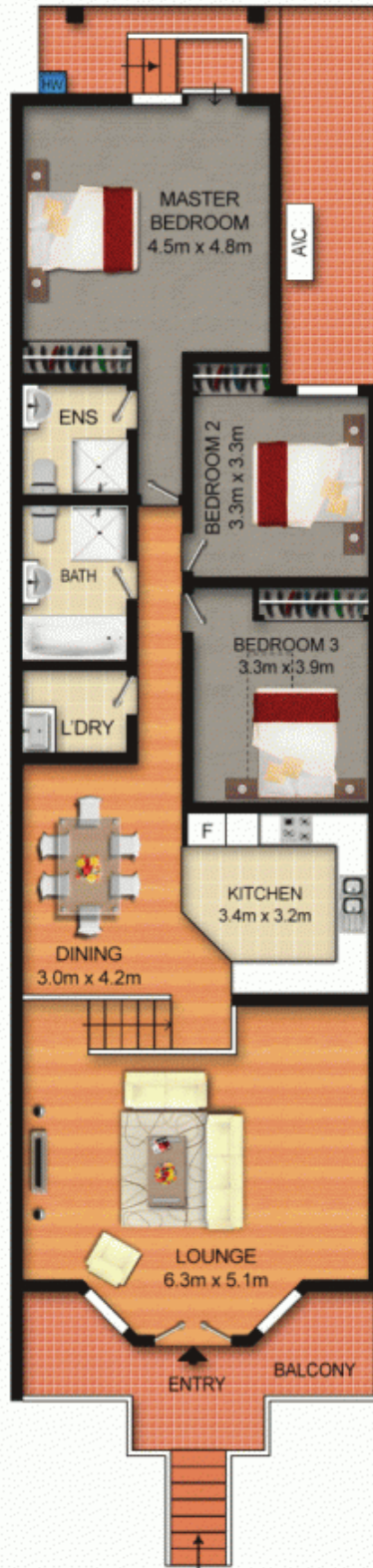

Scale shown in metres. All dimensions herein are approximate and gathered from sources believed to be reliable. Whilst every effort is made for the accuracy of our floor plans, interested parties should rely on their own enquiries. Floor Plans by Industrie Media | industriemedia.tv



S2

4/2 Crowley Crescent, Melrose Park