



18/1 Bay Drive MEADOWBANK NSW

1 1 1

Ideally positioned to the north-western side of the building with light-filled interiors, this modern 1 bedroom apartment, situated directly across the road from Parramatta River, is centrally located to major public transport links in a vibrant and sought-after locale. This executive residence will perfectly suit an outgoing professional or astute investor for years to come. Other features include:

View : <https://www.awardgroup.com.au/sale/nsw/northern-suburbs/meadowbank/residential/unit/5230266>

Property Highlights:

- Spacious north-facing bedroom complete with built-in robe
- Open-plan lounge room with ample dining space
- Quality kitchen with gas cooking appliances, built-in microwave and granite benchtops



Leighton Avery
(02) 9808 1199

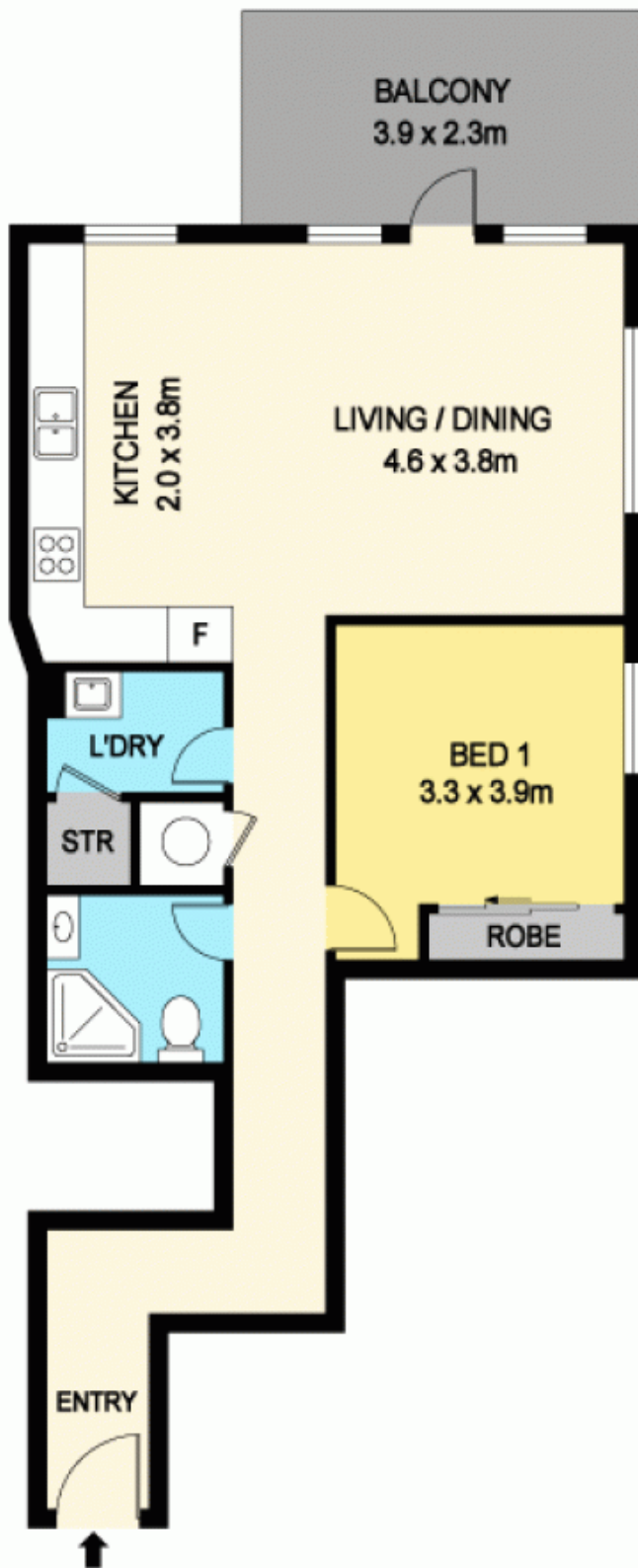

18/1 BAY DRIVE, MEADOWBANK

DISCLAIMER

PLANS SHOWN ARE FOR MARKETING PURPOSES ONLY. ALL DIMENSIONS ARE APPROXIMATE AND NOT TO SCALE. THEY ARE SUBJECT TO ERRORS AND INACCURACIES AND NO LIABILITY WILL BE ACCEPTED. INTERESTED PARTIES SHOULD MAKE THEIR OWN INQUIRIES.