



**48 Epping Avenue EASTWOOD NSW**

3 2 1

Presenting an excellent opportunity in an enviable location, this character filled home offers an idyllic family lifestyle with significant scope to enhance and personalise. It rests in a prized, blue ribbon location, and is set on a generous parcel of land, with a wide street frontage. Within walking distance of Eastwood Station, buses, shopping centre, schools, and entertainment, you are sure to be impressed.

Beyond its picturesque facade, you'll find a blend of traditional elements and modern refinements throughout. From the fresh neutral tones and polished timber floor boards, to the ornate ceilings and its leafy surrounds, it is a home of comfort, and presents an opportunity for the whole family.

- Welcoming front verandah with tessellated tiles, flowing to tastefully finished entry foyer

**View :** <https://www.awardgroup.com.au/sale/nsw/northern-suburbs/eastwood/residential/house/5230326>



**David Johnson**  
**(02) 9808 1199**

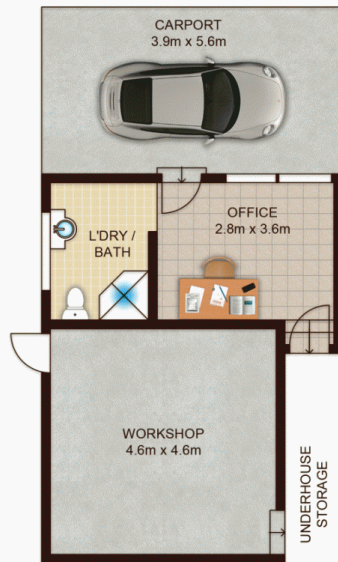

**BASEMENT**



**GROUND FLOOR**

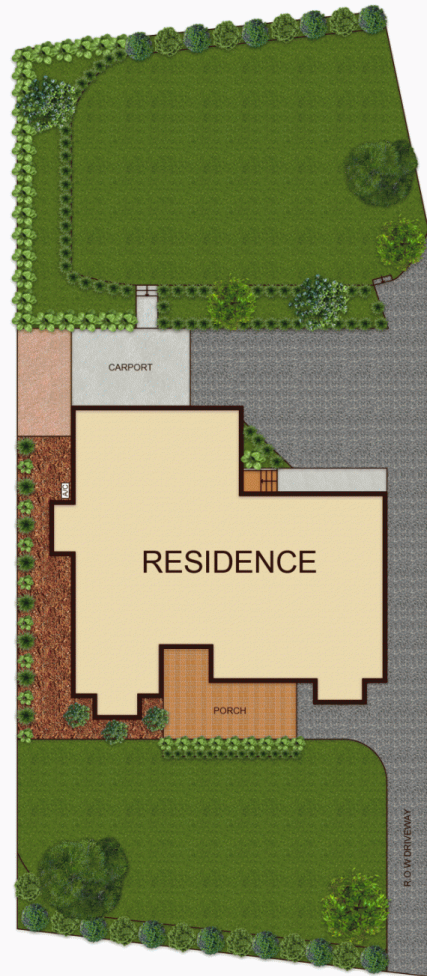

**SITE PLAN**

